

Powerwash Lenovo 100e Gen3

******You need to use the keyboard as the mouse will not function in this mode******

- 1.) Turn off the Chromebook.
- 2.) Press Esc+Refresh+Power.

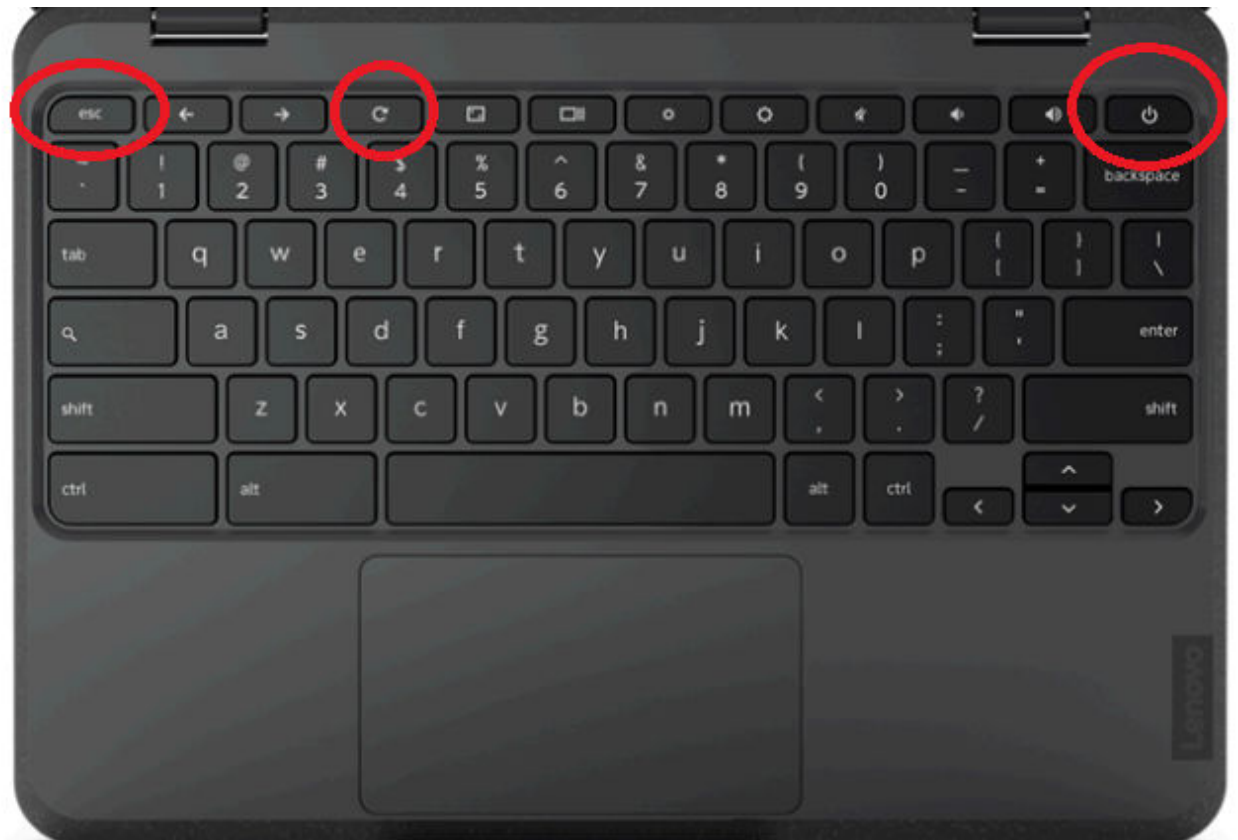

3.) Choose “Advanced options”

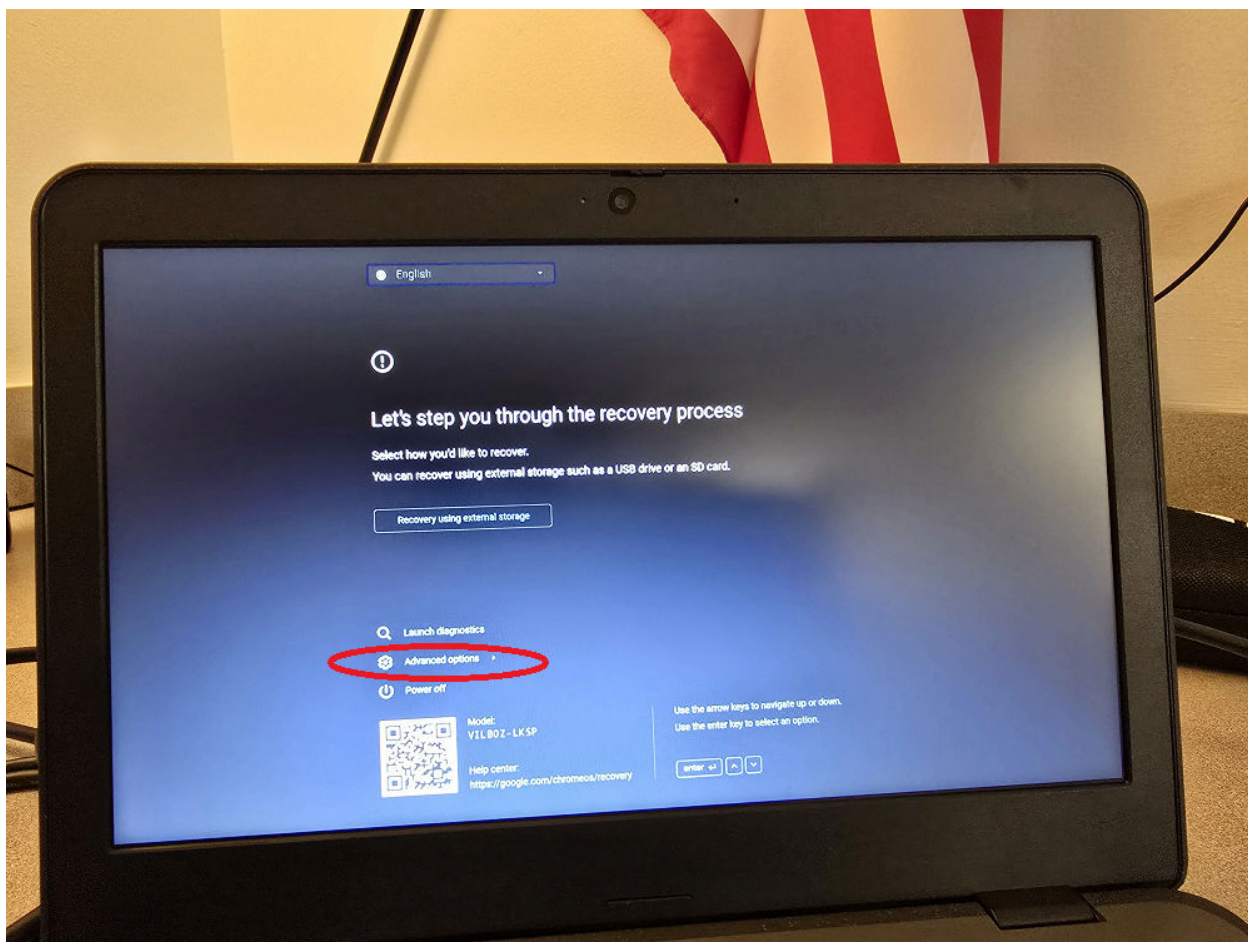

4.) Choose "Enter developer mode"

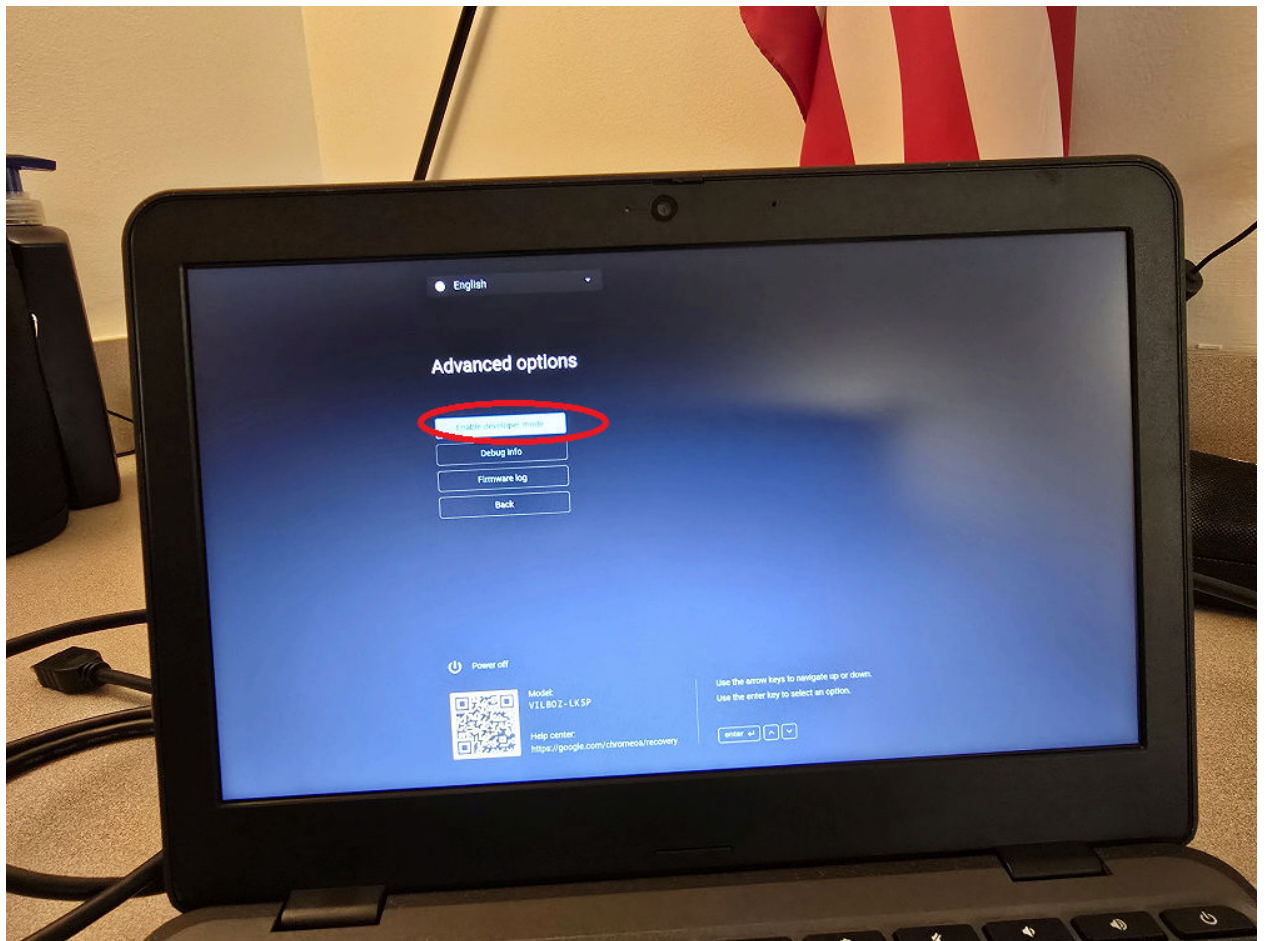

- 5.) You will see the following message, “You are attempting to enable developer mode” choose “Confirm”

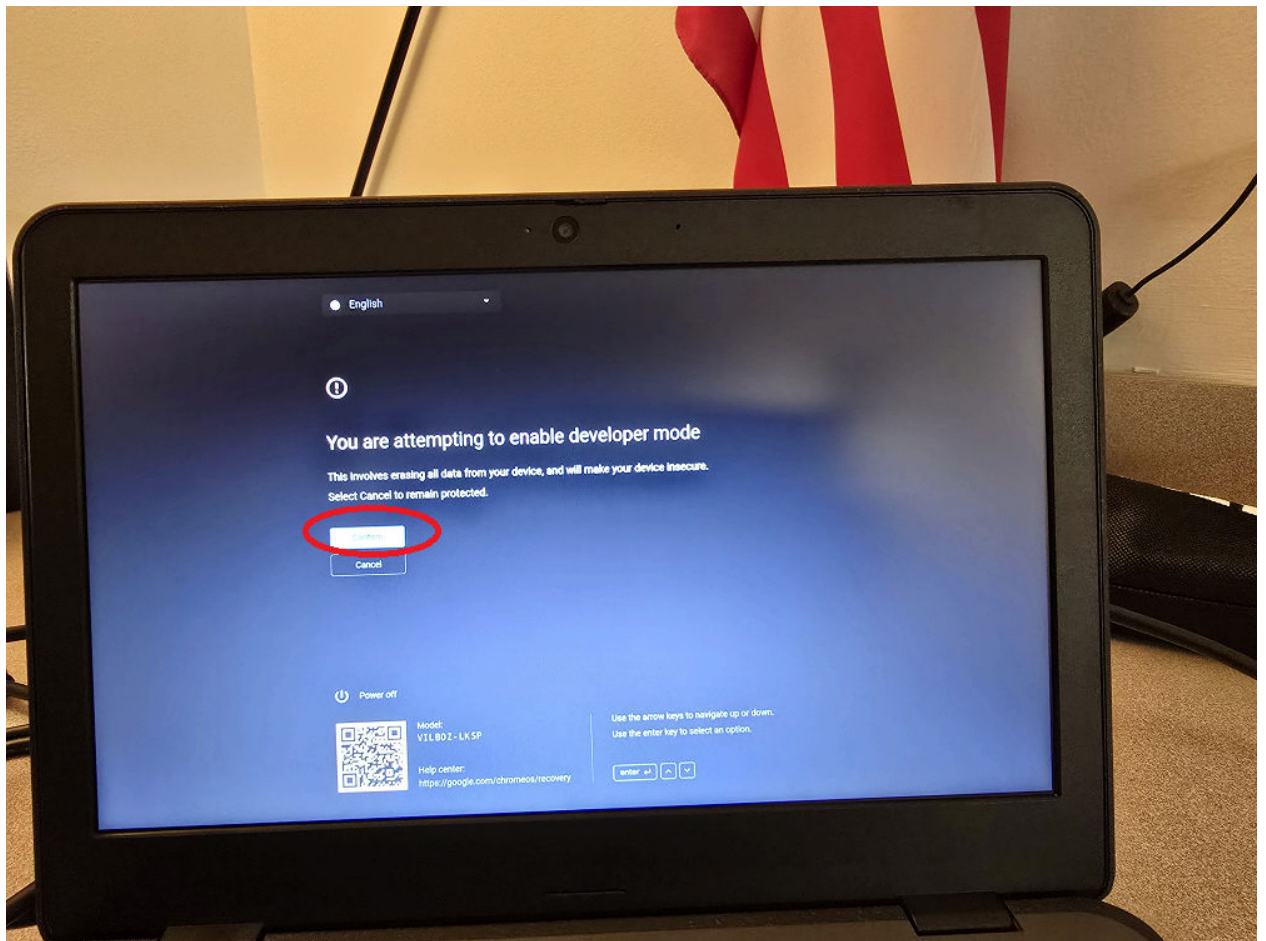

- 6.) You will then see the following message “Confirm returning to secure mode” Choose “Confirm”

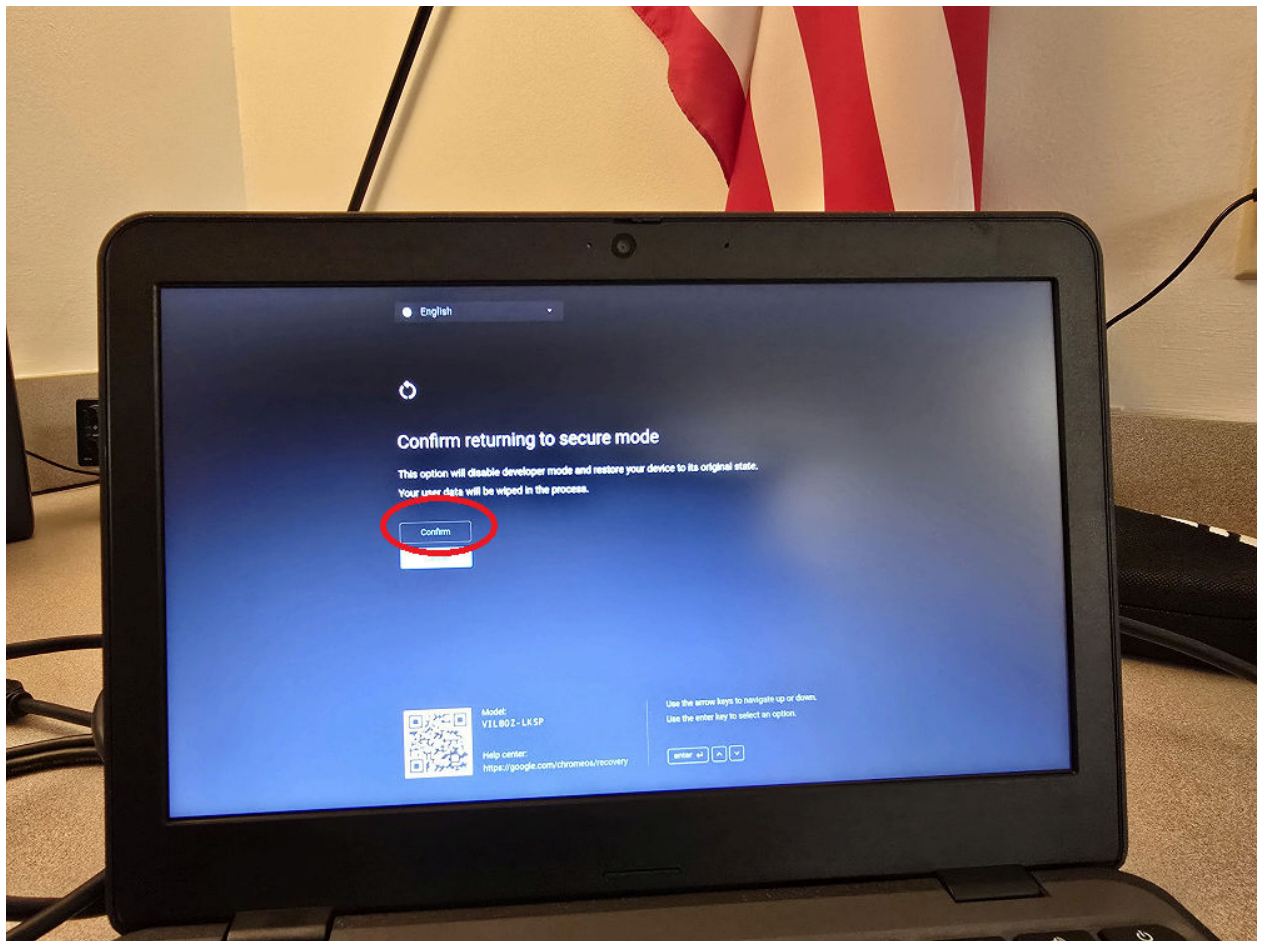

- 7.) When the Chromebook displays a “Welcome!” screen, please choose “Lets Go”
- 8.) Connect to your WiFi or NPSD_Guest (if in a school building)
- 9.) Agree to Google Chrome OS terms by choosing “Accept and continue”
- 10.) You may or may not be asked to Enroll your device into enterprise enrollment. If you are asked, just enter your email and password.
- 11.) If asked for asset tag information, please DO NOT CHANGE this number and click Next

12.) Your Chromebook is now ready to be used.